

Models W1, W1.1, W1L, W1.1L
UNITROL PRESSURE CONTROL SET
 with Chemical Injector *

FEATURES

- Reduces Cost – Eliminates the need for fittings and bypass hose.
- Compact Design – Features forged brass body and hardware.
- Versatile – Mounts in seconds to either side of pump manifold.
- Adjustable Unloader Valve – (Trapped pressure type with internal bypass system).
- Built-In Chemical Injector – Includes variable metering adjustment.



General Pump recommends using a safety relief device in conjunction with this unloader valve when installed on a positive displacement pump. General Pump is not liable and assumes no responsibility for this valve when used in a customer's high pressure system.

SPECIFICATIONS

Flow Range	W1, W1L	2-3 GPM
	W1.1, W1.1L	3-4 GPM
Maximum Pressure	1600 PSI	
Maximum Temperature	165°F	
Inlet Port	W1, W1.1	3/8-19 BSPP - F
	W1L, W1.1L	1/2-14 BSPP - F
Outlet Port	3/8-19 BSPP - M	
Chemical Inlet	1/4 in. I.D. Hose	
Weight	2.5 lb.	
Dimensions	7.25 x 2.75 x 5.25 in.	

Model W1, W1L

2-3 GPM

Model W1 used on pump models	TT551, TT561, TT741, TT751, TT901, TT931, T9051, TT9061, TT9071, TS1021
Model W1L used on pump models	T521, T531, T701, T721, T731, T981, T9721, T9731, T9791

Model W1.1, W1.1L

3-4 GPM

Model W1.1 used on pump models	TT661, TT941
Model W1.1L used on pump models	T711, T911, T991, T9951, T9961

- * Notes: 1. All Unitrol models may be ordered without chemical injector by adding suffix letters "SC" to order.
 2. Optional suction nipple/O-ring available -- see parts list.



W1 CONTROL SET

GENERAL PUMP INCORPORATED

PARTS LIST

W1 Pressure Control Set

No.	Part No.	Description	Repair Kit	Qty.
1.	90.3839.00	O-Ring	W1, W1.1	1
	93.1972.00	Washer	W1L, W1.1L	1
2.	98.2057.00	Cap		1
3.	10.0078.70	Nipple		1
4.	90.3832.00	O-Ring	KIT 94	1
5.	90.3833.00	O-Ring	W1, W1.1	1
	93.1858.00	Washer	W1L, W1.1L	1
6.	36.3167.66	Valve	T 98	1
7.	90.5025.00	Anti-Ext. Ring	KIT 98	1
8.	90.3575.00	O-Ring	KIT 98	1
9.	90.5075.00	Anti-Ext. Ring	KIT 98	1
10.	90.3589.00	O-Ring	KIT 98	1
11.	36.3165.70	Valve Guide	KIT 98	1
12.	90.3847.00	O-Ring	KIT 98	1
13.	36.3166.70	Bushing Guide	KIT 98	1
14.	94.7436.00	Spring		1
15.	36.3169.70	Spring Plate		1
16.	36.3171.02	Knob		1
17.	92.2200.00	Nut		1
18.	99.3052.00	Screw		1
19.	36.3172.51	Cap		1
20.	90.5065.00	Anti-Ext. Ring	KIT 98	2
21.	90.3822.00	O-Ring	KIT 94, 98	2
22.	36.3168.66	Control Piston	KIT 98	1
23.	97.6132.00	Pin	KIT 98	1
24.	97.4800.00	Ball	KIT 98	1
25.	36.3164.66	Valve Seat	KIT 98	1
26.	36.3163.01	Valve Body	W1, W1.1	1
	36.3173.01		W1L, W1.1L	1
27.	90.3820.00	O-Ring	W1, W1.1	1
	90.3827.00		W1L, W1.1L	1
28.	36.2567.70	Valve Bolt	W1, W1.1	1
	36.2568.70		W1L, W1.1L	1
29.	90.3825.00	O-Ring		2
30.	36.3152.22	Connector	W1, W1.1	1
	36.3174.22		W1L, W1.1L	1
31.	90.3827.00	O-Ring	W1, W1.1	1
	90.3841.00		W1L, W1.1L	1
32.	36.2568.70	Valve Bolt	W1, W1.1	1
	36.3175.70		W1L, W1.1L	1
	*36.90.3591.00	O-Ring		1
	*37.36.2584.70	Suction Nipple		1
46.	10.0151.66	Nozzle .079" (2.0mm) 2.1-2.9 gal/min.	W1, W1L	1
	10.0076.66	Nozzle 3.1-3.9 gal/min.	W1.1, W1.1L	1
47.	90.3582.00	O-Ring	KIT 94	1
48.	94.8217.00	Taper Spring	KIT 94	1
49.	97.4782.00	Ball	KIT 94	1
50.	90.3572.00	O-Ring	KIT 94	1
51.	90.3585.00	O-Ring	KIT 94	1
52.	36.2563.70	Chem. Valve Seat		1
53.	36.2562.51	Chem. Injector Body		1
54.	94.7383.00	Spring	KIT 94	1
55.	90.3580.00	O-Ring	KIT 94	1
56.	36.2564.70	Injector Shutter		1
57.	36.2565.51	Chem. Regulation Knob		1
58.	90.3570.00	O-Ring	KIT 94	2
59.	36.2566.70	Hose Barb Fitting		1

* OPTIONAL Item 36 and 37 must be ordered separately.

REPAIR KITS	Includes
KIT 94	4, 21, 47, 48, 49, 50, 51, 54, 55, 58
KIT 98	6, 7, 8, 9, 10, 11, 12, 13, 20, 21, 22, 23, 24, 25

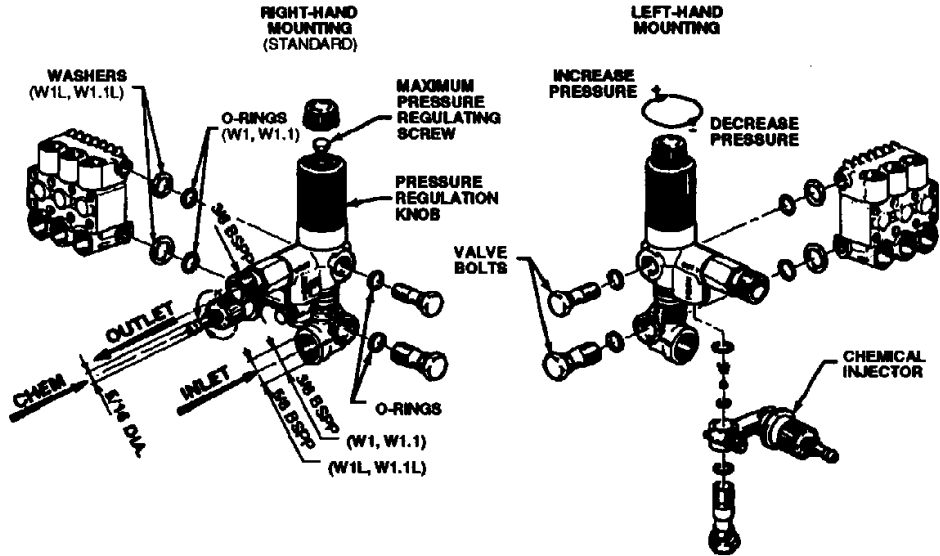

INSTALLATION

All Unitrol units are shipped ready for right-hand mounting to pump head. If left-hand mounting is desired, simply reverse chemical injector and valve bolts as shown in illustration.

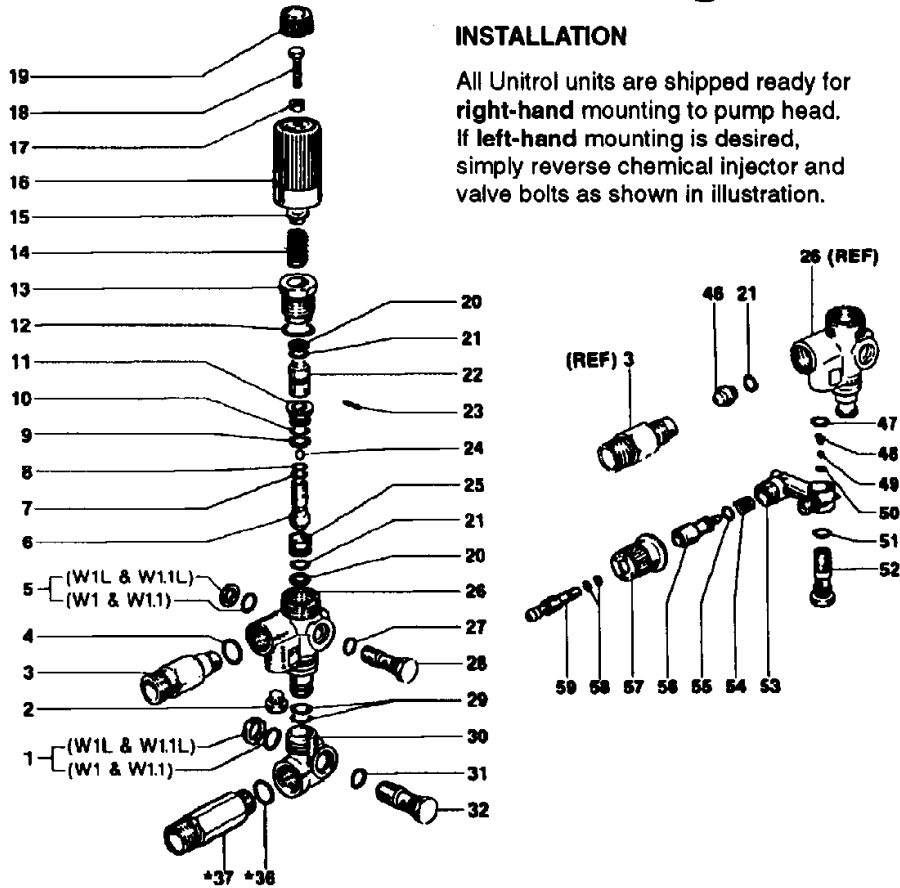

*OPTIONAL—MUST BE ORDERED SEPARATELY.

WARRANTY

General Pump accessories are warranted by the manufacturer to be free from defects in material and workmanship. Period of warranty shall be 90 days from date product is received by original buyer. Liability of manufacturer under the foregoing warranty is limited to repair or replacement at the option of manufacturer of that product which according to the manufacturer's investigation was deemed defective at time of shipment. Damage resulting from neglect, abuse, tampering or misapplication voids this warranty. This warranty is in lieu of all other warranties, expressed or implied, including any warranty of merchantability and/or any and all other obligations or liabilities on the part of the manufacturer.

